

*The Grande Dame
of
Pennsylvania
Avenue*



Retail Space Available





The Willard Intercontinental Washington DC is a celebrated landmark in the heart of Downtown Washington. A 4-star diamond luxury hotel with 335 rooms and suites, The Willard is one of the world's grandest and most iconic hotels. Known as the 'Resident of the Presidents', The Willard is steeped in history and luxury. A destination for weddings, glitzy galas and events of all types, The Willard sits at the pinnacle of social and political life in Washington.

◆ 870 square feet available on F Street, with an additional 90 square foot vitrine.

◆ 2,242 square feet available in the courtyard with expansive storefront.

◆ Located at 14th Street and Pennsylvania Avenue, The Willard enjoys heavy traffic, 7 days a week from tourists, local residents, business travelers and proximate daytime population.

◆ Available Immediately



New York Avenue

OLD
EBBITT
GRILL

The HAMILTON
DUTCH HOUSE LONDON

G Street



F Street

JW MARRIOTT
WASHINGTON DC

The National Theatre

15th Street

14th Street

Pennsylvania Avenue

Available Areas

A. 870 sf

B. 2,242 sf

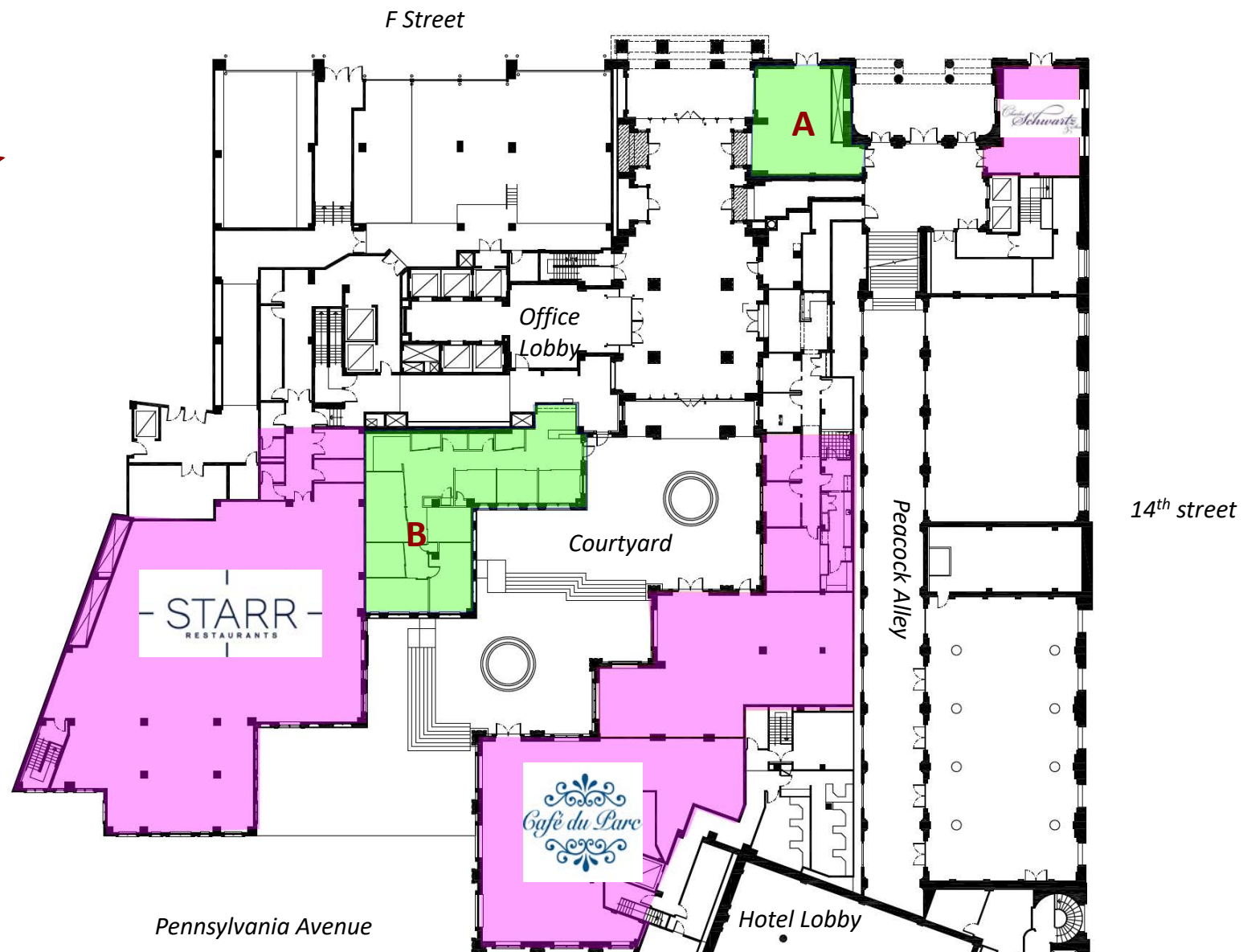

Courtyard - Storefronts

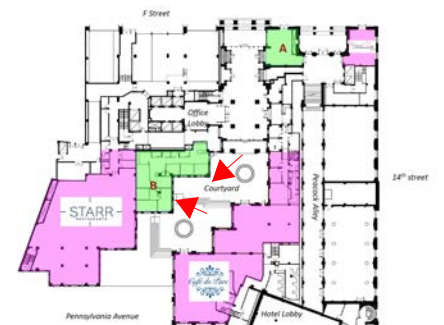

F Street - Storefronts



Interior



Promenade



Vitrine



Storefront



For Leasing Info



John Asadoorian
703.624.5790
john@asaretail.com