

For Sublease

# LLOYD CENTER TOWER

*±5,591 SF Office Space  
Available for Sublease in  
Portland, Oregon*

825 NE MULTNOMAH ST  
PORTLAND, OR 97232

KIDDER.COM

**km** Kidder  
Mathews







*Beautiful Class A office space located in the amenity rich Lloyd District, that includes ample parking options and a easy access to public transit.*

ADDRESS	825 NE Multnomah St Portland, OR 97232
TOTAL SIZE	5,591 SF
SUBLEASE ASKING RATE	\$25.00/SF , full service
EXP. DATE	12/31/2026
FURNITURE	Available
RENOVATION	Recently renovated space with beautiful views

**5.6K SF**  
AVAILABLE

**\$25 FSG**  
SUBLEASE RATE (SF/YR)

# FLOOR PLAN

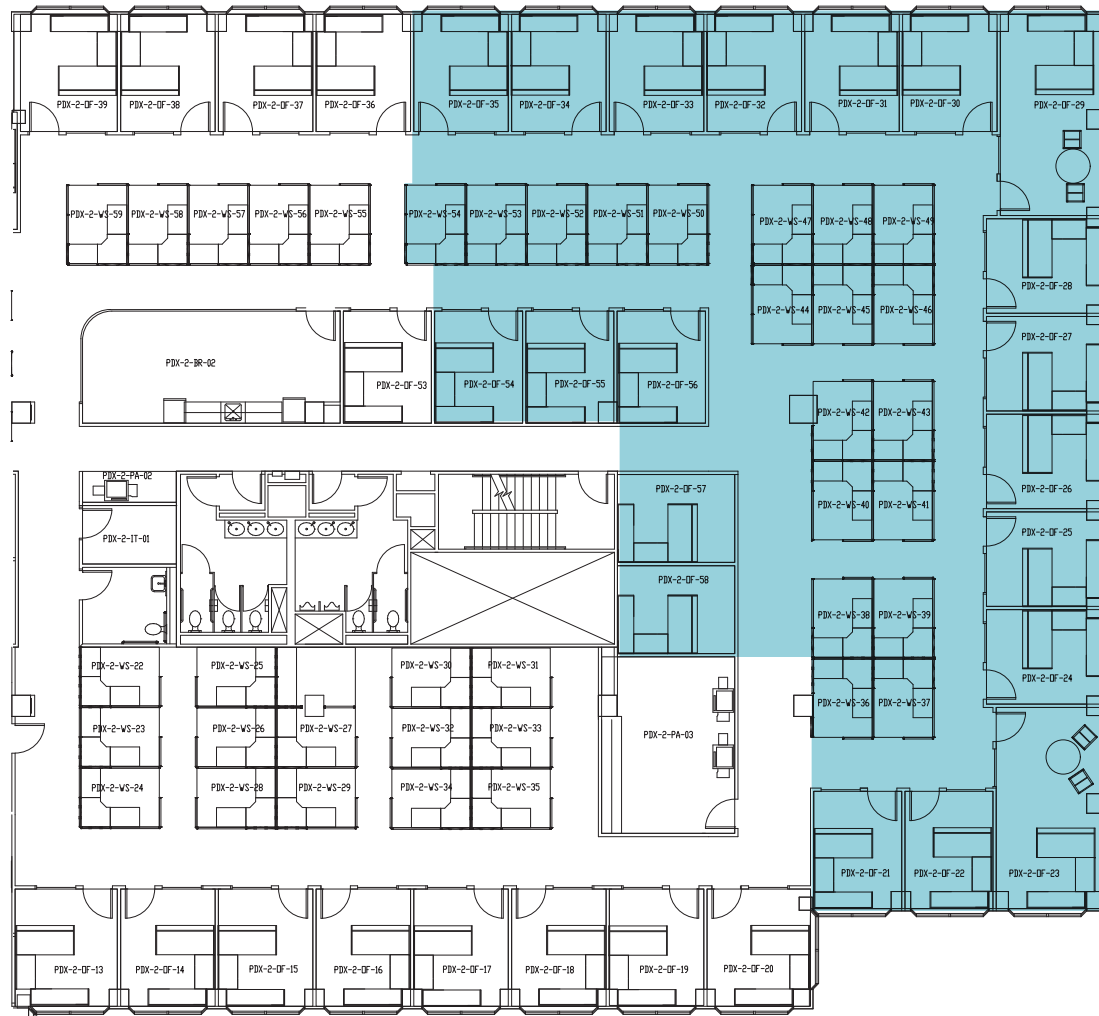

*5,591 SF*

AVAILABLE

*18*

PRIVATE OFFICES

*2*

CONFERENCE/HUDDLE ROOMS

*READY TO USE*

ABUNDANT WORKSTATIONS



LLOYD CENTER TOWER





# LLOYD CENTER TOWER

*Exclusively subleased by*

GRANT GUERNSEY

503.721.2737

[grant.guernsey@kidder.com](mailto:grant.guernsey@kidder.com)

[KIDDER.COM](http://KIDDER.COM)

This information supplied herein is from sources we deem reliable. It is provided without any representation, warranty, or guarantee, expressed or implied as to its accuracy. Prospective Buyer or Tenant should conduct an independent investigation and verification of all matters deemed to be material, including, but not limited to, statements of income and expenses. Consult your attorney, accountant, or other professional advisor.

**km** Kidder  
Mathews