



FOR SUBLEASE

BANNER BANK BUILDING FULL FLOOR SUBLEASE

950 W Bannock Street, #300 Boise, Idaho

Lease through June 2030 - direct lease possible

- 16,394 RSF
- \$26/sf full service
- FF&E negotiable
- Exterior building signage possible
- Lots of glass and new finishes throughout!

Contact

Bill Beck

208.841.3530

beck@tenantrealtyadvisors.com

Greg Gaddis

208.869.9294

greg@tenantrealtyadvisors.com

950 W. Bannock St., Suite 400
Boise, ID 83702

TenantRealtyAdvisors.com

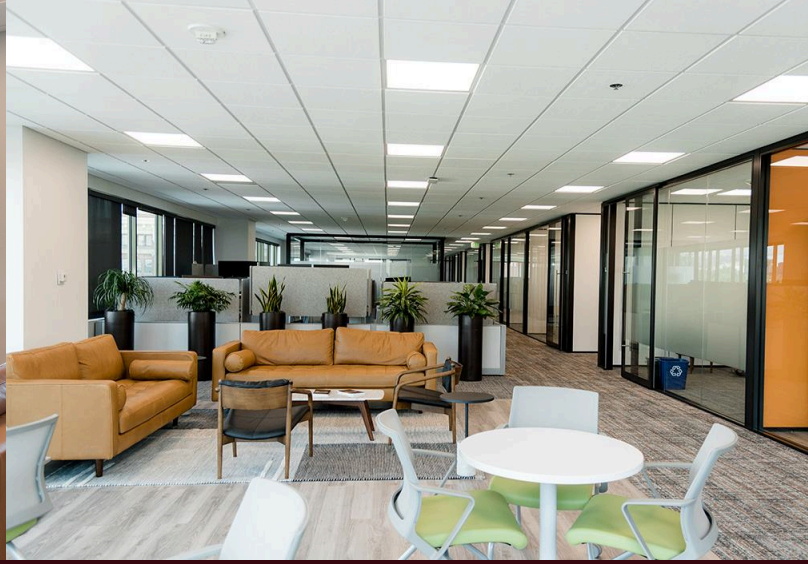

FLOOR PLAN

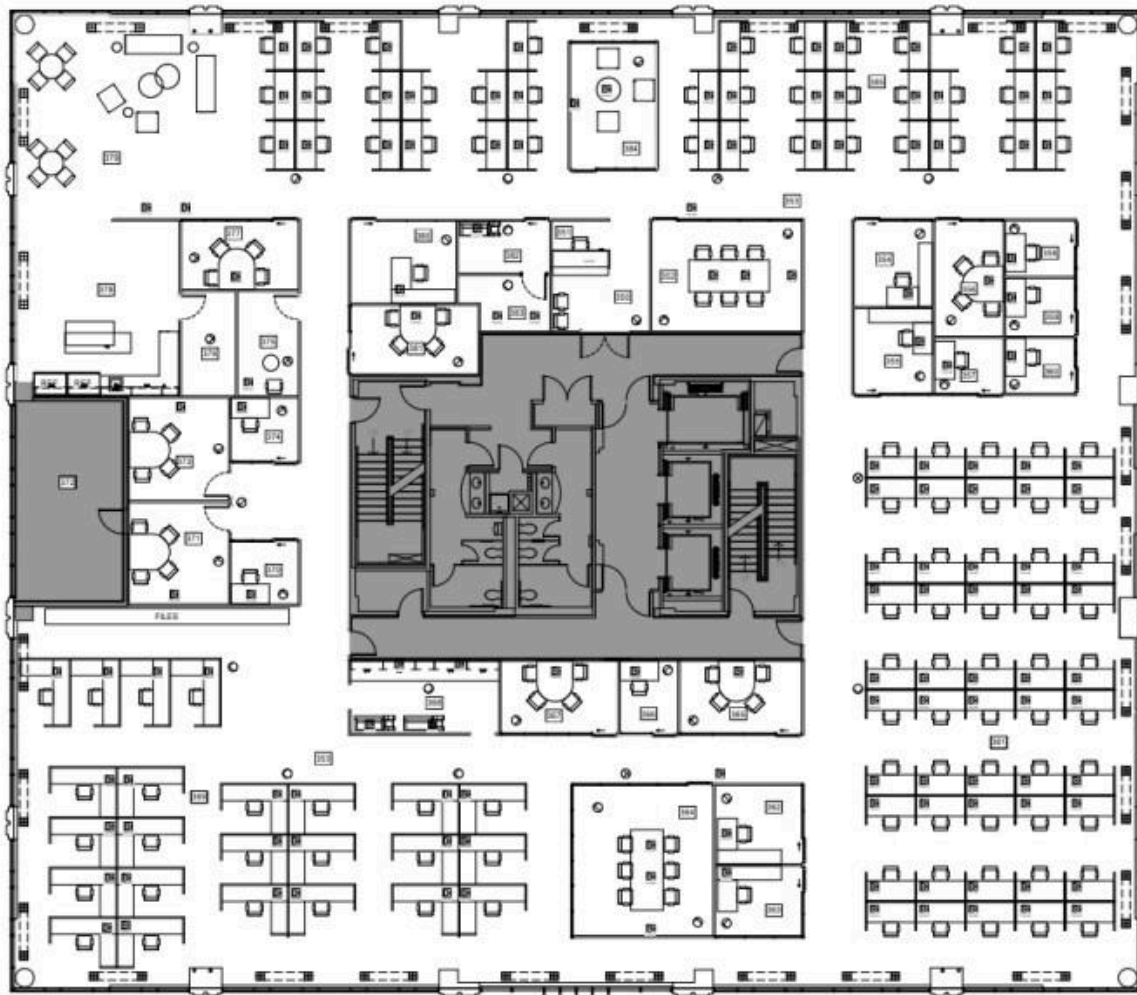

1 ACCESS FLOOR PLAN
A152 18' x 10'

16,394 RSF

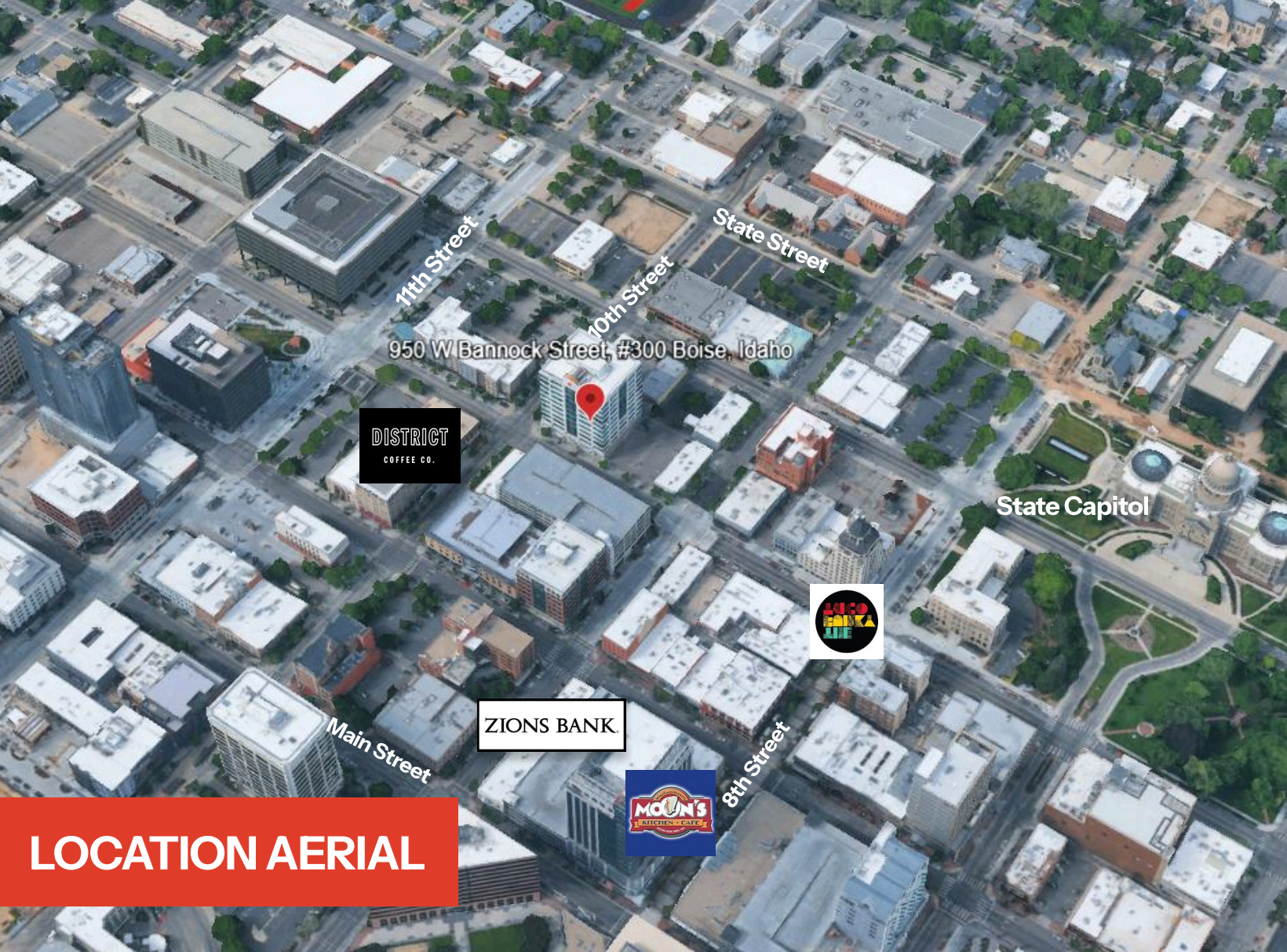

LOCATION AERIAL

950 W Bannock Street, #300
Boise, Idaho

- Garage parking available
- Cafes, coffee shops and restaurants walkable
- Hotel and Bank locations nearby
- New YMCA facility one block away
- LEED Platinum certified Green building
- Contact agent for showing instructions. Do not disturb Tenant.