

GRADING AND STORM DRAIN PLAN  
 PARKVIEW

WORKSHEETS  
 05.05.23 ADDRESS CITY COMMENTS  
 03.12.24 ADDRESS CITY COMMENTS  
 2.22.24 ADDRESS CITY COMMENTS  
 1.22.24 ADDRESS CITY COMMENTS  
 FOUND AT 1417 BOOK 99 PAGE 175  
 AS SHOWN ON THE PLAN  
 CITY OF FREDERICK COUNTY, MARYLAND  
 STAFF: JAY COOPER, PARKWAY 2  
 DATE: 5/23/2024 11:52 AM

Professional Certification: I hereby certify that these documents were prepared or approved by me, and that I am a duly licensed professional engineer under the laws of the State of Maryland.  
 License No. 28643 Expiration Date 12-26-25  

NOTE: TYPED ELEVATIONS ARE GRADE ELEVATION, NOT WALL ELEVATIONS.

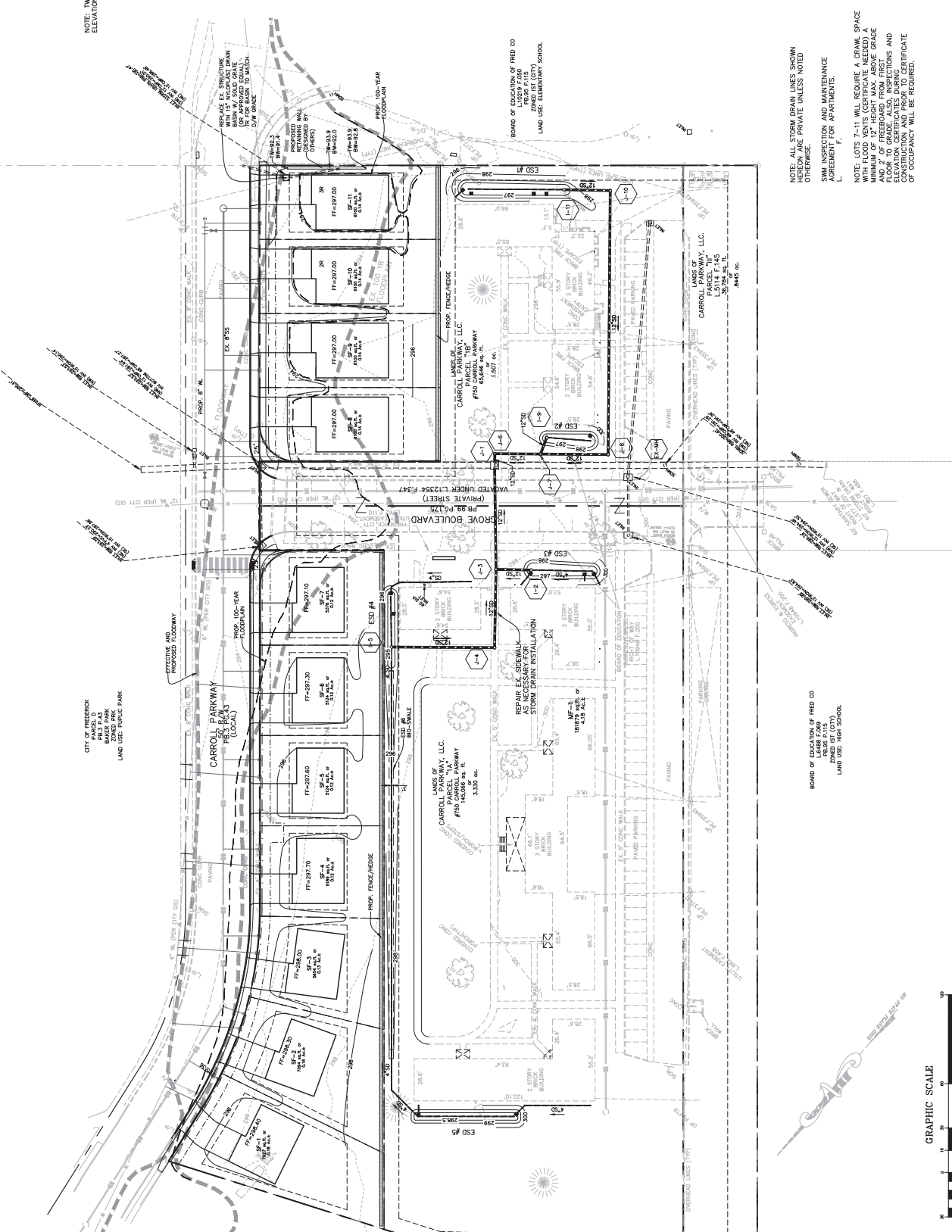

NOTE: ALL STORM DRAIN LINES SHOWN ARE PRIVATE UNLESS NOTED OTHERWISE.  
 SWM INSPECTION AND MAINTENANCE AGREEMENT FOR APARTMENTS.  
 NOTE: LOTS 7-11 WILL REQUIRE A DRAINAGE SPACE WITH FLOOD VENTS (CERTIFICATE NEEDED) A FLOOD VENT SHALL BE PROVIDED FROM ABOVE GRADE FLOOR TO GRADE. ALSO, INSPECTIONS AND MAINTENANCE SHALL BE PROVIDED TO CERTIFICATE OF OCCUPANCY WILL BE REQUIRED.

BOARD OF EDUCATION OF FRED CO  
 LAND USE: HIGH SCHOOL

JOHN R. & JILL A. ANUS  
 LAND USE: RESIDENTIAL

OWEN L. DAVIS & ANN F.  
 LAND USE: RESIDENTIAL

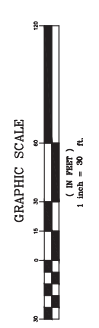

EX FLOODWAY  
 EX 150' FLOOD LANE

CITY OF FREDERICK  
 ZONED R4 (CITY)  
 ZONED R4 (LOCAL)  
 LAND USE: PUBLIC PARK

REPAIR EX STRUCTURE  
 BARR W/ SOLID GRADE  
 BY OR MATCH TO MATCH  
 D/F GRADE

REPAIR EX SIDEWALK  
 AS NECESSARY FOR  
 STORM DRAIN INSTALLATION

REPAIR EX SIDEWALK  
 AS NECESSARY FOR  
 STORM DRAIN INSTALLATION

REPAIR EX SIDEWALK  
 AS NECESSARY FOR  
 STORM DRAIN INSTALLATION

REPAIR EX SIDEWALK  
 AS NECESSARY FOR  
 STORM DRAIN INSTALLATION

REPAIR EX SIDEWALK  
 AS NECESSARY FOR  
 STORM DRAIN INSTALLATION

REPAIR EX SIDEWALK  
 AS NECESSARY FOR  
 STORM DRAIN INSTALLATION

REPAIR EX SIDEWALK  
 AS NECESSARY FOR  
 STORM DRAIN INSTALLATION

REPAIR EX SIDEWALK  
 AS NECESSARY FOR  
 STORM DRAIN INSTALLATION