

OFFICE SPACE FOR LEASE

1623 S.E. Washington Blvd. - Bartlesville, OK



PROPERTY HIGHLIGHTS

- AVAILABLE SPACE: 1,867 SF
- FLEXIBLE OPEN AREAS AND OFFICES
- SEVERAL SINKS IN PLACE FOR MEDICAL OR COSMETOLOGY USES
- WASHINGTON BOULEVARD FRONTAGE
- PLENTY OF GREEN SPACE AVAILABLE
- SITUATED AROUND PROFESSIONAL BUSINESSES & RESTAURANTS
- BASEMENT SPACE AVAILABLE FOR LEASE FOR AN ADDITIONAL CHARGE



Traffic Count	ODOT 2023
21,900 Vehicles per day	S. E. Washington Blvd.
7,200 Vehicles per day	Nowata Rd.



2024 Demographics	Source: ESRI		
	1 Mile	3 Miles	5 Miles
Population	7,159	33,684	42,567
Households	2,855	13,782	17,228
Average HH Income	\$130,595	\$107,954	\$101,805

OFFICE SPACE FOR LEASE

1623 S.E. Washington Blvd. - Bartlesville, OK

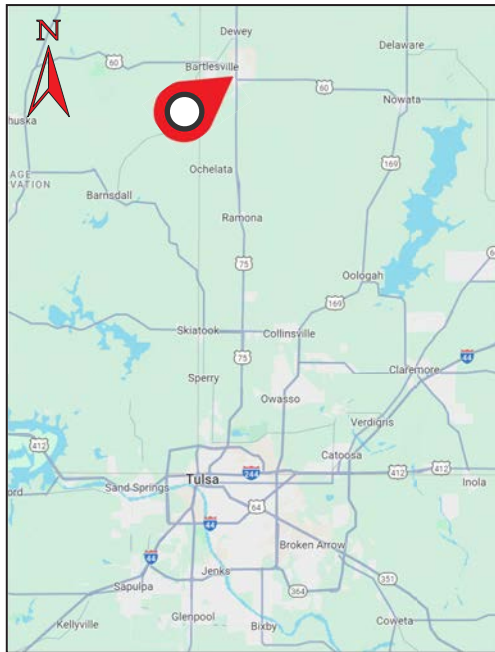

North East OK Area Map

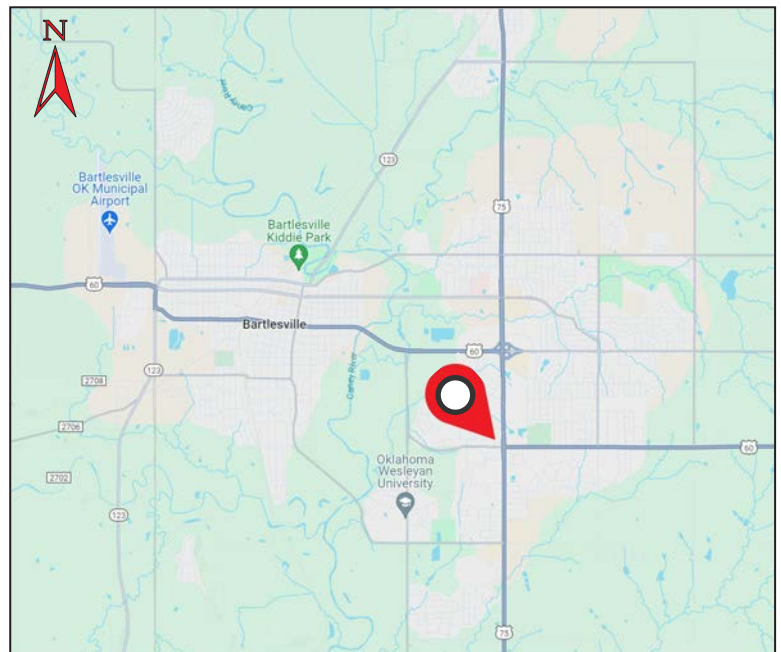

Bartlesville Area Map

NEARBY BUSINESSES

Armstrong Bank

Sonic Drive-In

O'Reilly Auto Parts

Farmers Insurance

QuikTrip

Walgreens

BAUER & ASSOCIATES, REALTORS®

"A LEADER IN TULSA COMMERCIAL REAL ESTATE SINCE 1979"

Commercial - Industrial - Investment Property - Property Management

6846 S. Canton Ave., Suite 100, Tulsa, OK 74136

All statements herein are for information purposes only and are believed to be reliable; however, no warranty or representation is made as to the accuracy thereof and the same is submitted subject to errors, omissions, change of price, terms, conditions and prior sale or lease.

SHEILA COOPER

Office: 918-665-1210

Cell: 918-724-5140

scooper@bauertulsa.com