

14505 Hayden Rd, Suite C | Scottsdale, AZ 85260

PLUG & PLAY

SUBLEASE AVAILABLE



±20,079 RSF Divisible to ±8,500 RSF

 **EXPIRES**
June 30, 2028

 **ASKING RATE**
\$32.00 FSG

 **FURNITURE**
INCLUDED

 **PARKING**
4.5:1000

SUITE C

EXPIRES
June 30, 2028

ASKING RATE
\$32.00 FSG

FURNITURE
INCLUDED

PARKING
4.5:1000

±20,079 RSF

Divisible to ±8,500 RSF

- **11** Offices
- **2** Conference Rooms
- **1** Huddle Room
- **2** Storage Rooms
- **1** Training Room
- **1** Electrical Room
- **1** IT Room
- **1** Maintenance Room
- **5** In-Suite Restrooms
- **1** Break Area
- **207** Workstations

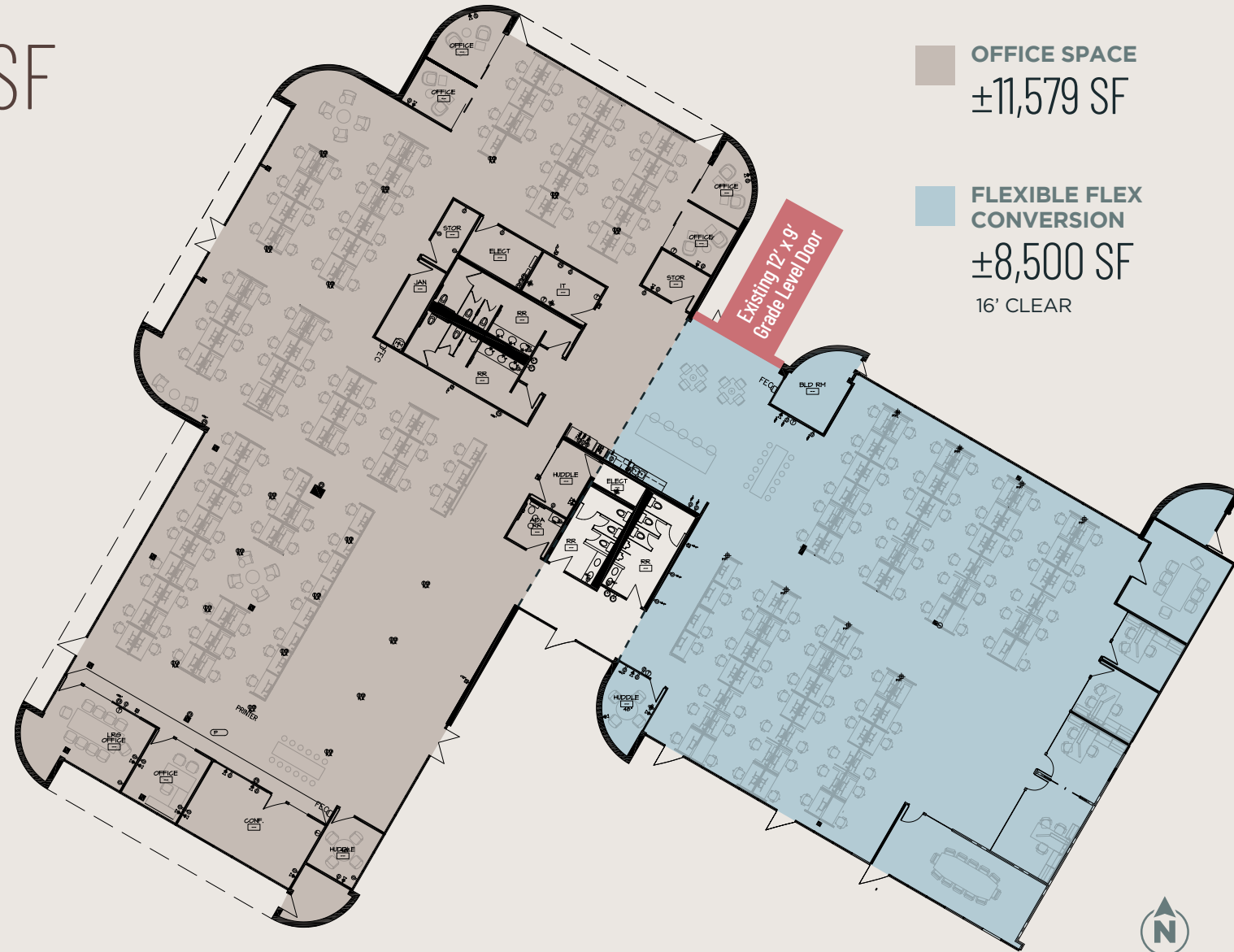

NOT TO SCALE

WORKSTATIONS



OFFICE



HUDDLE ROOM

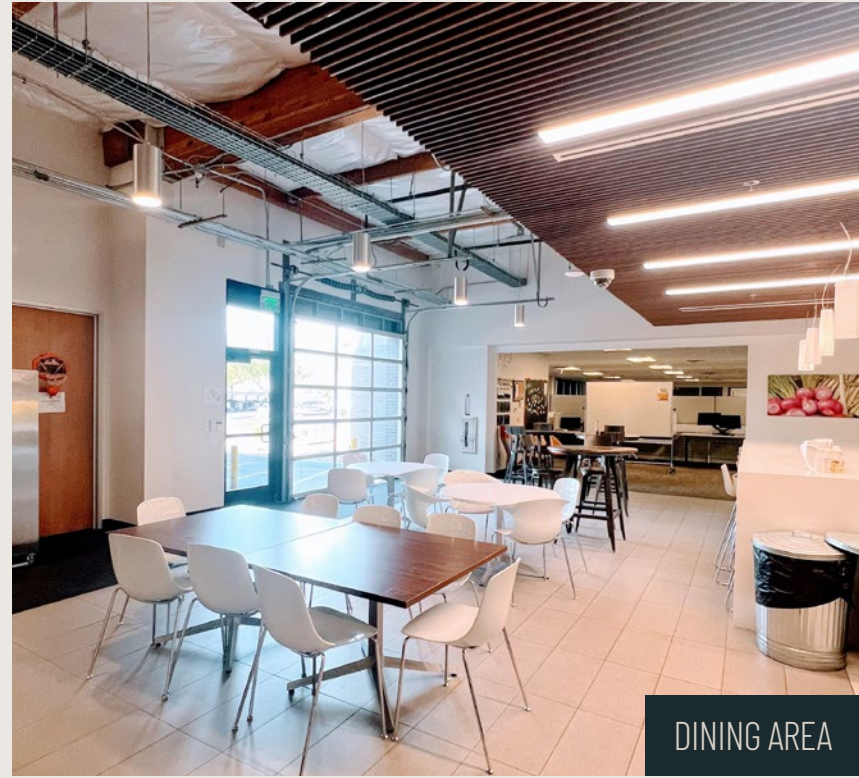



LOCAL AMENITIES

Centered between North Scottsdale's premier retail centers with incredible amenities including;

NORTHSIGHT CROSSING

SONORAN VILLAGE

SCOTTSDALE TOWN CENTER

SCOTTSDALE QUARTER

KIERLAND COMMONS

SCOTTSDALE PROMENADE

FOR MORE INFORMATION, PLEASE CONTACT

Kevin Calihan

kevin.calihan@cbre.com

602.735.5676

Tim Kempton

tim.kempton@cbre.com

602.735.5631

CBRE

©2025 CBRE, Inc. All rights reserved. This information has been obtained from sources believed reliable, but has not been verified for accuracy or completeness. You should conduct a careful, independent investigation of the property and verify all information. Any reliance on this information is solely at your own risk. CBRE and the CBRE logo are service marks of CBRE, Inc. All other marks displayed on this document are the property of their respective owners. Photos herein are the property of their respective owners. Use of these images without the express written consent of the owner is prohibited.