

# 1259 - 1263 NORTH SR 135

THE POINTE / GREENWOOD, IN



For Sublease / Retail Space Available

WE ARE  
THE CENTER  
OF RETAIL



## RETAIL SPACE

11,018 SF

## RENT

\$12.00/SF NNN

## NEIGHBORING TENANTS

Raymond James, J.L. Johnson Jewelers, Friendly Smiles Dentistry, Code Ninja, Wings Etc

## PROPERTY HIGHLIGHTS

- Located along busy SR 135, near County Line Road, Pylon Sign & Ample Parking
- Area offers a strong demographic profile, Johnson County
- Prime retail space available
- Lease term ends August 31, 2027

**Carmen Thompson** / Senior Associate / [carmen.thompson@cushwake.com](mailto:carmen.thompson@cushwake.com) / +1 317 352 5430  
**Russell A. Van Til** / Director / [russell.vantil@cushwake.com](mailto:russell.vantil@cushwake.com) / +1 317 639 0546

WE ARE  
THE CENTER  
OF RETAIL

# 1259 - 1263 NORTH SR 135

THE POINTE / GREENWOOD, IN



## NEIGHBORHOOD DEMOGRAPHICS



POPULATION

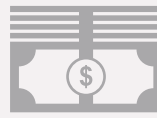

AVERAGE  
HOUSEHOLD INCOME



DAYTIME  
POPULATION

	POPULATION	AVERAGE HOUSEHOLD INCOME	DAYTIME POPULATION
1 Mile	9,420	\$125,294	4,747
3 Miles	88,876	\$108,177	45,406
5 Miles	175,331	\$110,039	94,010

**Carmen Thompson** / Senior Associate / [carmen.thompson@cushwake.com](mailto:carmen.thompson@cushwake.com) / +1 317 352 5430  
**Russell A. Van Til** / Director / [russell.vantil@cushwake.com](mailto:russell.vantil@cushwake.com) / +1 317 639 0546

**WE ARE  
THE CENTER  
OF RETAIL**

# 1259 - 1263 NORTH SR 135

THE POINTE / GREENWOOD, IN

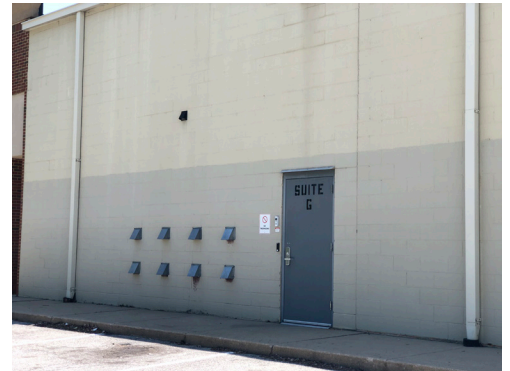

**Carmen Thompson** / Senior Associate / [carmen.thompson@cushwake.com](mailto:carmen.thompson@cushwake.com) / +1 317 352 5430  
**Russell A. Van Til** / Director / [russell.vantil@cushwake.com](mailto:russell.vantil@cushwake.com) / +1 317 639 0546

**WE ARE  
THE CENTER  
OF RETAIL**