

# TINWERK - LOVELAND

## MODERN

## WORKSHOP SPACES

Flexible Industrial Units Designed for Makers, Fabricators & Entrepreneurs

TINWERK's workshop spaces are designed for makers, contractors, fabricators, artisans, and light industrial users seeking a modern, flexible workspace. Each suite features high clear ceilings, a grade-level glass overhead door, a private restroom, energy-efficient heat pump HVAC, and dedicated storefront parking, all with outstanding visibility and convenient access to Highway 287 and Interstate 25.

## AVAILABLE WORKSHOPS

UNIT	SF	RATE	NNN	Monthly
313	1,223	\$14.00	\$5.10	\$1,946.61
311	1,244	\$14.00	\$5.10	\$1,980.03
341	1,237	\$14.00	\$5.10	\$1,968.89
319	1,218	\$14.00	\$5.10	\$1,938.65
351	1,239	\$14.00	\$5.10	\$1,972.08
353	905	\$14.00	\$5.10	\$1,440.46

\*Monthly total includes base rent + NNN(estimated at \$5.10psf)

**Building B**



**Building C**

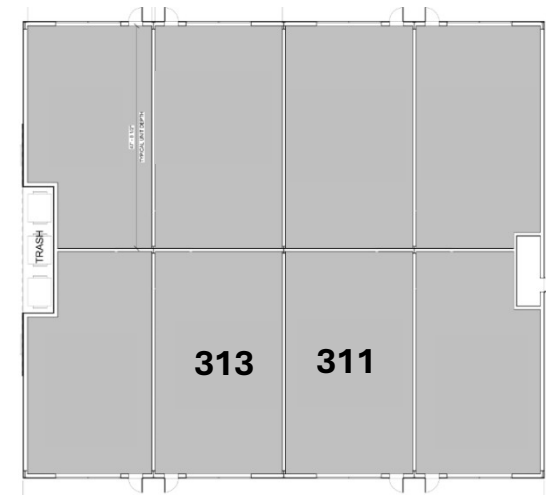

Jim York - Managing Broker  
 Phone: 303-717-8038  
 E-mail: [jyork@summitcommercial.net](mailto:jyork@summitcommercial.net)



Co-Listed By:



All information provided is deemed reliable, but is not guaranteed and should be independently verified.