

# PIER 33 1/2

Waterfront Restaurant Opportunity For Lease



**Kazuko Morgan**

Executive Vice Chairman | Lic. 01070005  
kazuko.morgan@cushwake.com  
T. 415 773 3546

**Jennifer Hibbitts**

Senior Director | Lic. 0148027  
jennifer.hibbitts@cushwake.com  
T. 415 451 2433

**Heather Trimble**

Senior Associate | Lic. 02041605  
heather.trimble@cushwake.com  
T. 415 299 6683



# OPPORTUNITY

Pier 33 1/2 is located on the Embarcadero along the waterfront and a short walk from San Francisco's financial, recreational, and cultural centers. The premises benefits from a high volume of pedestrian and vehicular traffic, a variety of retail and entertainment options, as well as a wide network of transit options, including San Francisco's Ferry Terminal, the Transbay Terminal, BART and the I-80 East Freeway.

The Waterfront Corridor also includes San Francisco's largest aggregation of sports and entertainment venues, including Oracle Park (home to the San Francisco Giant's MLB team), Chase Center (the home of the Golden State Warriors), the artisanal Ferry Building, and kid friendly Exploratorium museum.

## IN CLOSE PROXIMITY:

The Ferry Building Marketplace, the Bay Bridge, Pier 39 - Fisherman's Wharf, Levi's Plaza, and the Hyatt Regency San Francisco

**FUTURE** Boudin Bakery Café at Pier 31



# A RENOWNED DESTINATION ON THE WATERFRONT

PIER 33 1/2 hosts unmatched views of San Francisco Bay with spectacular floor-to-ceiling windows, an open kitchen, and a large and airy dining room.

Fully revitalized and activated in the last 15 years, the Embarcadero has emerged as an inimitable destination in the city of San Francisco for both locals and visitors alike. Offering generous bike paths, a wide promenade, and a striking assembly of restaurants, entertainment, and open-air beauty, it is undoubtedly the beating heart of the neighborhood



**TOURISTS IN 2022**  
21.5 MILLION



**VISITOR SPENDING**  
\$6.7 BILLION



**RESIDENTIAL POPULATION**  
52,500 (1 mile)



**AVERAGE INCOME**  
\$127,603 (1 mile)



## ALCATRAZ LANDING AT PIER 33 1/2

- Average annual visitor count: 1.6 MILLION
- Departure point for all Alcatraz visitors
- The ferry leaves Alcatraz every 30 minutes
- Open everyday from 9AM to 5PM

# PREMISES

## RESTAURANT OPPORTUNITY

Premises	± 4,918 RSF
Outdoor Deck	± 330 RSF
Storage	± 330 RSF

## HIGHLIGHTS

- Frontage on the Embarcadero
- Waterfront view
- High visitor traffic

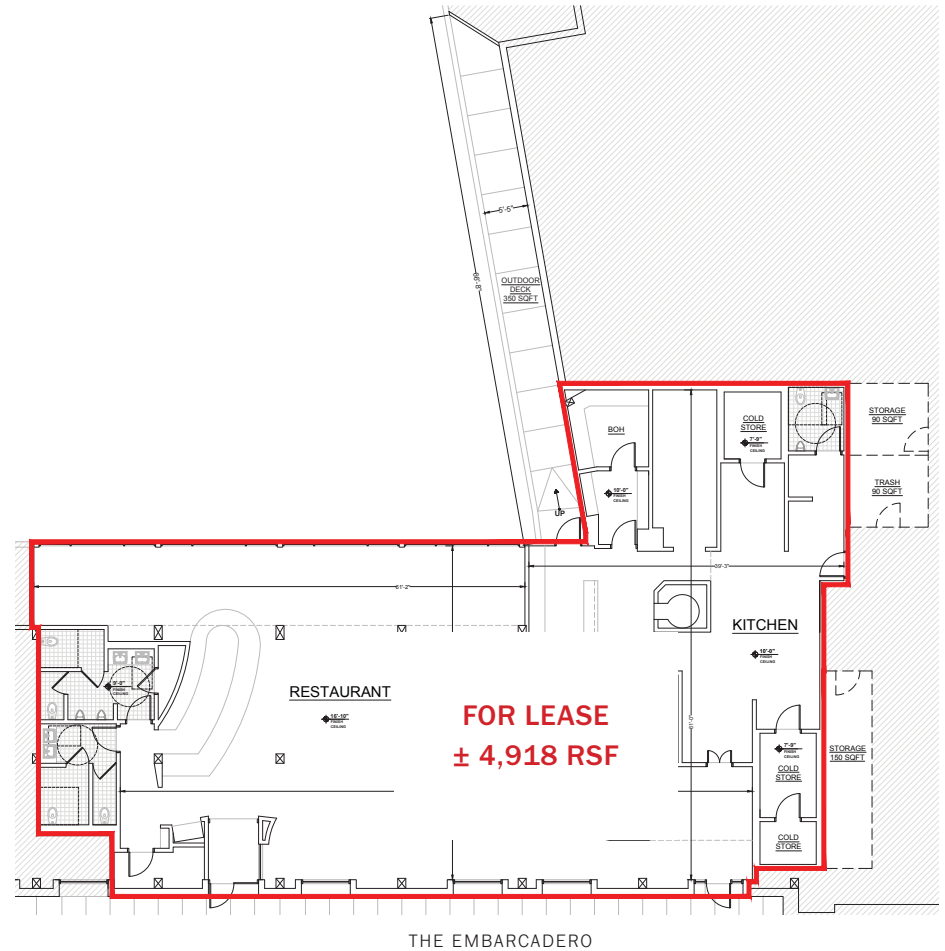

# PREMISES



# PROXIMITY



# PIER 33 1/2

Waterfront Restaurant Opportunity For Lease



**Kazuko Morgan**

Executive Vice Chairman | Lic. 01070005  
kazuko.morgan@cushwake.com  
T. 415 773 3546

**Jennifer Hibbitts**

Senior Director | Lic. 0148027  
jennifer.hibbitts@cushwake.com  
T. 415 451 2433

**Heather Trimble**

Senior Associate | Lic. 02041605  
heather.trimble@cushwake.com  
T. 415 299 6683

