

OFFICE CONDO | ± 574 SF

23232 Peralta Drive, Unit 103, Laguna Hills, CA

For Sale



SOUTH POINTE II

FEATURES

- Units 103 : ± 574 SF office condo
- Offering Price: \$30,000.00
- Free Surface Parking
- Excellent 5, 405, and 133 freeway access
- Available immediately
- LAND LEASE expires 12/31/2036
- No Options to renew or purchase land
- Association dues are \$776 a month (including land lease payment)

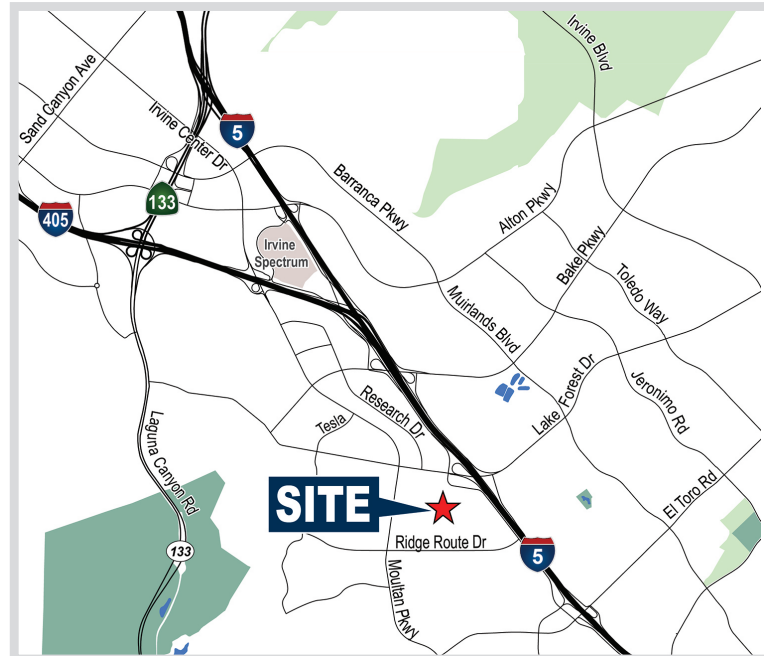

MATT TURCUTTO

949.310.7280
mturcutto@voitco.com
Lic. #01921491

2020 Main Street, Suite 100, Irvine, CA 92614 • 949.851.5100 • 949.261.9092 Fax

Voit

REAL ESTATE SERVICES

www.VoitCo.com

OFFICE CONDO | ± 534 SF

23232 Peralta Drive, Unit 103, Laguna Hills, CA

For Sale

Floor Plan

Unit 103

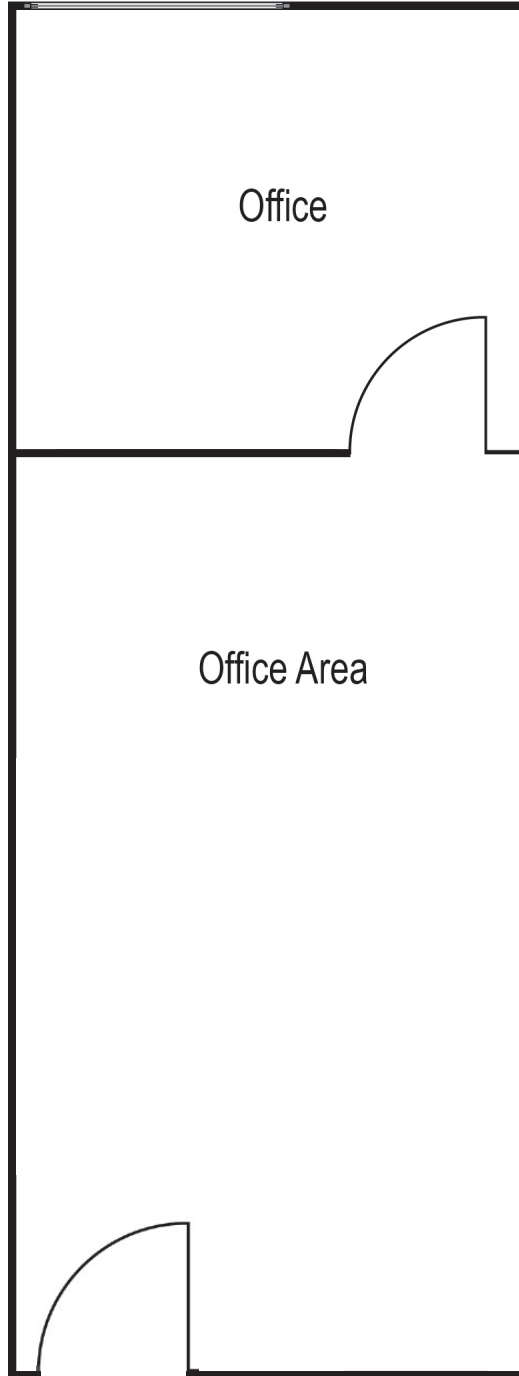

MATT TURCUTTO

949.310.7280

mturcutto@voitco.com

Lic. #01921491

2020 Main Street, Suite 100, Irvine, CA 92614 • 949.851.5100 • 949.261.9092 Fax

Licensed as a Real Estate Salesperson by the DRE. The information contained herein has been obtained from sources we deem reliable. While we have no reason to doubt its accuracy, we do not guarantee it. ©2022 Voit Real Estate Services, Inc. All Rights Reserved. Lic. #01991785

Voit

REAL ESTATE SERVICES

www.VoitCo.com